

DESCRIPTION: —

TARRIF# 7604.29.10.00

PROPOSAL# 38603-1

DATE

SYM

REVISION

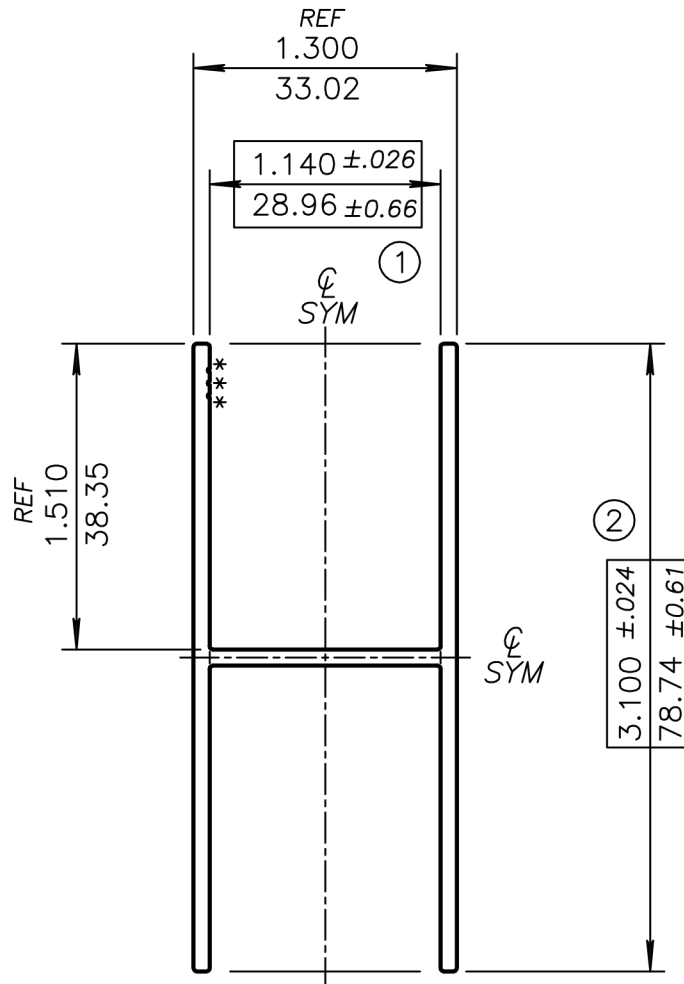

UNMARKED RADII = RADIUS TO SUIT  
BREAK CORNERS = 0.016 (0.41) R.

(\*) = 0.010(0.25) R. X 0.010(0.25)D. HYDRO I.D. MARKS



UNSPECIFIED WALL THICKNESS

(3) 0.080(2.03)  
±0.006(0.15)

EST. AREA 0.587 IN<sup>2</sup> 378 MM<sup>2</sup> OUT PER. — IN — MM

EST. WT. 0.704 LBS/FT. 1.048 KG/M FACTOR 21

EST. PER. 14.792 IN 376 MM C.C.D. 3.352 IN 85 MM

DWN BY Gareth ALLOY 6063-T5 SCALE 1:1 DATE 26,03,2021

BREAK ALL CORNERS .016"R (0.41 mm)R UNLESS OTHERWISE NOTED.

STANDARD ALUMINUM ASSOCIATION TOLERANCES TO APPLY UNLESS OTHERWISE SPECIFIED