

DESCRIPTION: 3/4" X 1/2" RECTANGULAR TUBE	TARRIF# 7604.21.00.00	PROPOSAL# 19238-2
DATE	SYM	REVISION

Buyer acknowledges and agrees that: (i) these structural values are theoretical in their derivation and are not intended to be relied on by Buyer; (ii) a registered Structural Engineer should be employed by Buyer for the determination of the suitability of the material and assemblies for Buyer's specific use; and (iii) HYDRO is not responsible for Buyer's use of such structural values for any purpose.

IX .008 in <sup>4</sup>	IY .004 in <sup>4</sup>
SX .022 in <sup>3</sup>	SY .017 in <sup>3</sup>
CGX .375 in	CGY .250 in

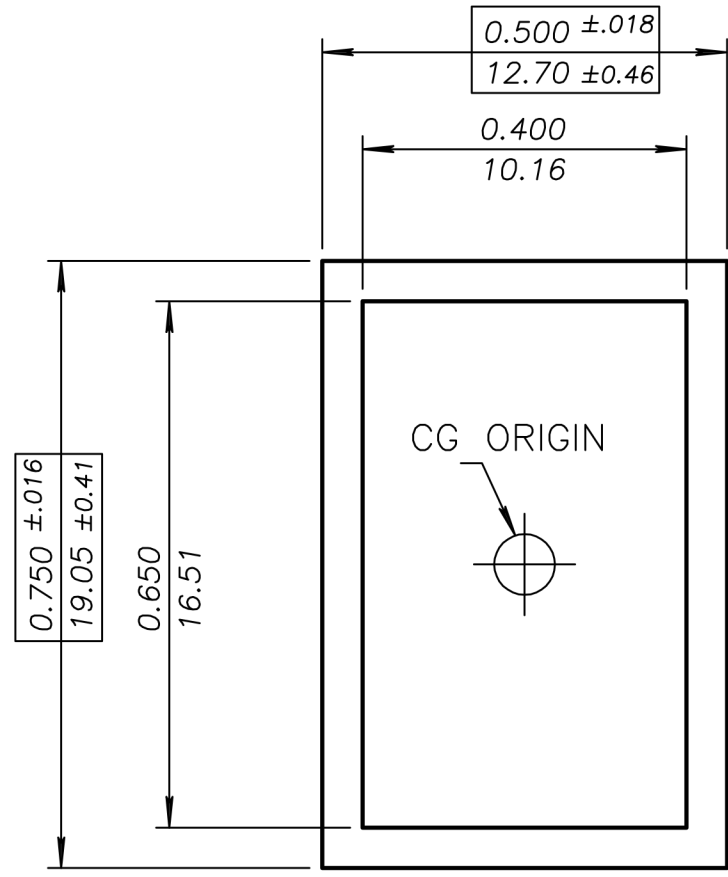

ACTUAL SIZE  
GRANDEUR ACTUELLE

*NITRO-GROOVED BACKER  
ZERO BEARINGS*

**RUN WITH BAFF RING  
ONLY**

EXPOSEE TOUT  
LE TOUR

EXPOSED SURFACE  
ALL AROUND

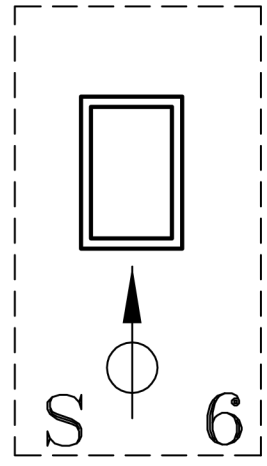

UNSPECIFIED WALL THICKNESS
0.050(1.27) ±.010 ±0.25

EST. AREA 0.115 in <sup>2</sup> 74 mm <sup>2</sup>	OUT PER. 2.500 IN 64 MM
EST. WT. 0.138 LBS/FT. 0.205 KG/M	FACTOR 33
EST. PER. 4.600 IN 117 MM	C.C.D. 0.901 IN 23 MM
DWN BY SM	ALLOY 6063-T5
SCALE 4:1	DATE 01/04/20